

INSTALLATION INSTRUCTIONS

DESCRIPTION: Front Cowl Kit
PART NUMBER: B9T-F83J0-V0
MODEL: 2020+ MT-03



⚠ WARNING

Please read and understand these instructions completely before installation to avoid possible injury, or damage to the accessory or vehicle.

NOTICE:

Installation of this kit requires a torque wrench and should be performed by an authorized Yamaha dealer or a qualified mechanic.

WARRANTY INFORMATION:

In the United States, see your Yamaha dealer for a copy of the Yamaha Genuine Parts and Accessories Limited Warranty.

DEALER OR INSTALLER:

These instructions contain important information for future reference and *must* be given to the customer.

PARTS LIST:

No.	Part Number	Description	Qty
--	B9T-F83J0-V0	Front Cowl Kit	--
①	-	Windshield	1
②	-	Left Brace	1
③	-	Right Brace	1
④	-	M6x25 Flanged Button Head Bolt	2
⑤	-	M5 Insert	4
⑥	-	Flat washer	4
⑦	-	M5 Button Head Screws	4
⑧	-	Edging material	1
⑨	-	Retainer Clip	2

* Part supplied with kit only and not available separately.

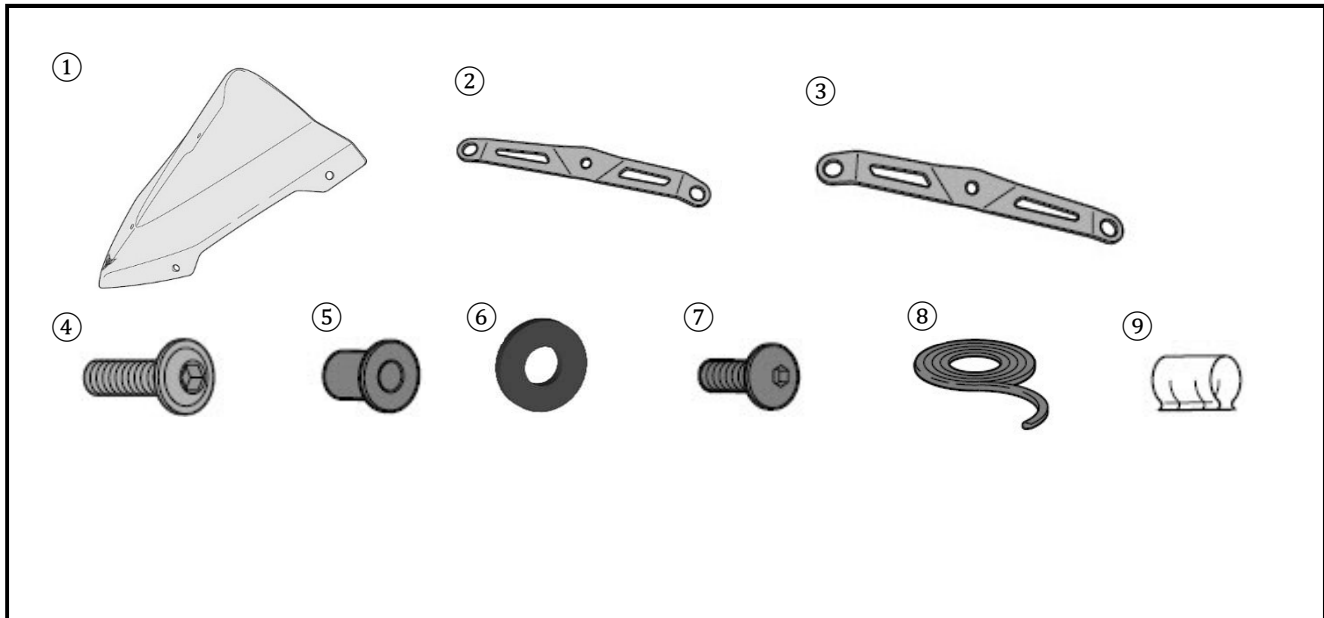

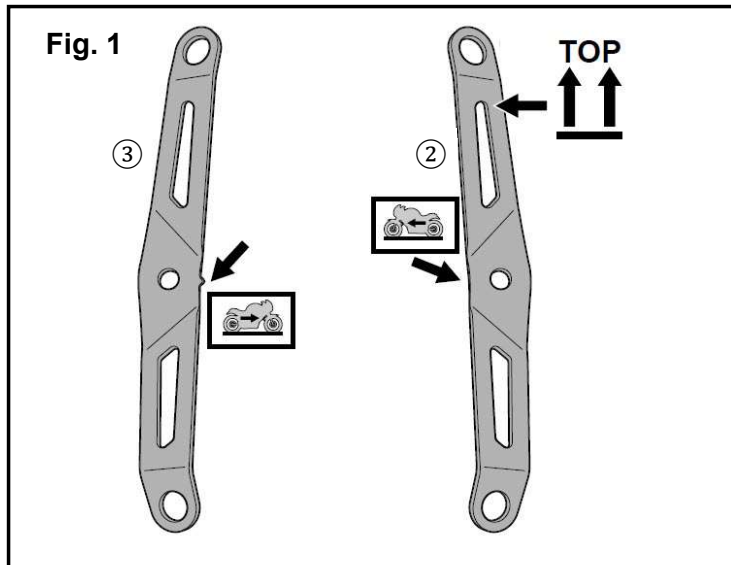

PREPARATION:

- Place the vehicle on a secure and level surface.
- Clean the mount surfaces before beginning installation.

INSTALLATION:

1. Open the kit and orientate the ② Left and ③ Right Braces. (Fig. 1)
2. Remove the stock hardware and install the ② Left and ③ Right Braces with two ④ M6x25 Flanged Button Head Bolts. (Fig. 2)
3. Torque to 7Nm (0.7 kg-m or 5.1 lb-ft)
4. Install four ⑤ M5 Inserts into the top and bottom holes in the braces. (Fig. 2)
5. Align the ① Windshield over the braces and thread in four ⑦ Button Head Screws with four ⑥ Flat Washers. (Fig. 3)
6. Torque to 5Nm (0.5 kg-m or 3.6 lb-ft)

Optional Steps for the Edge Trim:

7. Place the ⑧ Edging Material across the top of the ① Windshield and trim to fit.
8. Insert a ⑨ Retainer at each end of the ⑧ Edging material

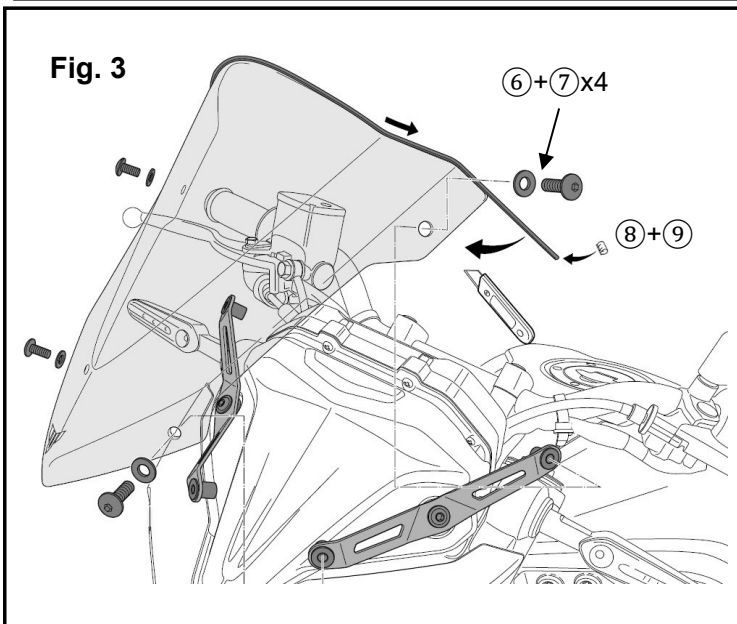
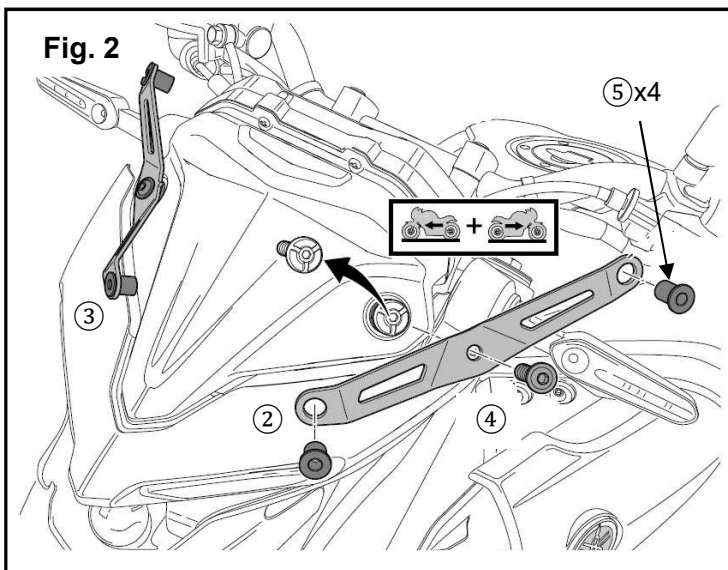

MAINTENANCE:

Periodically, check torque on all hardware. If loose hardware is found, re-torque to specification.

CARE AND CLEANING:

Clean painted metal parts with a clean soft cloth and mild soap and water solution. Rinse and dry.

CUSTOMER SERVICE:

For further information see your Yamaha dealer.

ESTIMATED TIME TO INSTALL: 0.5 HRS.